



RANDALL'S ADVENTURE & TRAINING RAT CUTLERY COMPANY

60 Randall Rd.
Gallant, AL 35972
Ph: (865) 933-8436
FAX: (256) 570-0175
www.jungletraining.com
www.ratcutlery.com



RAT Fire Kit™

The RAT Fire Kit is a "last-ditch" fire starter and mini survival kit container. The watertight capsule has plenty of storage space for tinder, fishhooks, line and other essential survival tools (user supplied). The Fire Kit can be clipped to a belt or vest, carried in your pack or put in the glove box of your vehicle. The compact size and light weight make this kit a very unique survival tool for hikers, adventurers, campers, hunters or anyone else who ventures into the wilds.

The RAT Fire Kit uses a Misch Metal flint. It does not produce a shower of sparks like standard Ferro rods. When struck with a sharp edge, the Misch Metal flint produces small balls of molten particles that burn hotter and have a longer burn time than the sparks made by a standard fire flint. This rod has been proven to light difficult tinder that regular flint won't, thus the reason for using this type of flint in a "last-ditch" survival kit. The Misch Metal flint requires a very sharp edge to strike. We suggest using the edge of your knife as a striker. This kit is a real survival tool, and in a true survival situation it won't matter if you dull a small part of your knife's edge in exchange for building a life-sustaining fire.

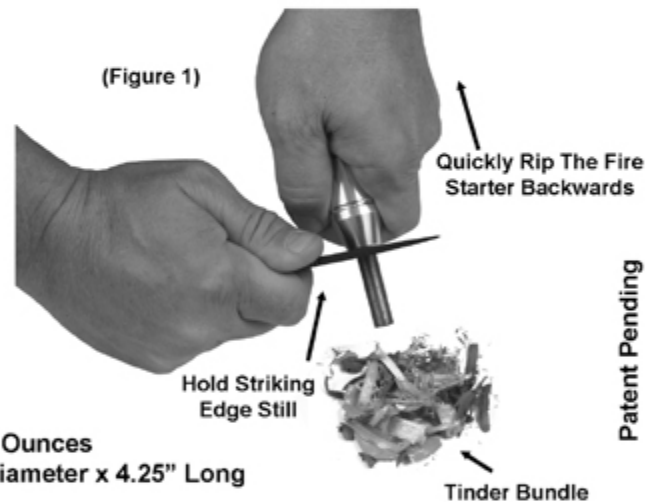
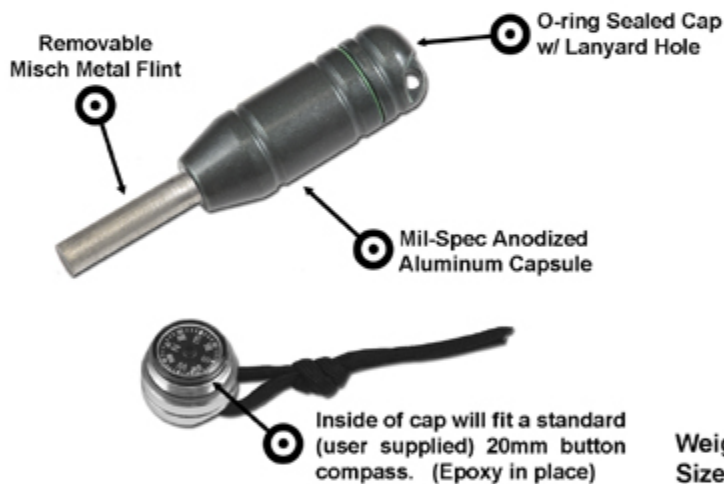

Weight: 2.5 Ounces
Size: 1.0" Diameter x 4.25" Long

Fire Kit Instructions and Fire Building Tips

Fire building is a step-by-step process with preparation being the key to success. Sources for reliable tinder that will catch readily from a small spark are bird and mouse nests, various tree barks, dead grasses, pocket lint, dry leaves or pre-packaged tinder. Once you have a good tinder bundle, gather progressively larger wood and have this ready before starting your fire.

Hold the fire starter over the top of your tinder bundle, then place the knife edge at the top of the flint rod and quickly move the fire starter backwards allowing the knife edge to scrape down the flint rod while holding the knife still (See Figure 1 above). Keep striking until your sparks hit the tinder and ignite it. Using this method, you will avoid hitting and scattering your tinder bundle and also keep the sparks directed into the tinder. Once you have a flame, add more tinder and begin placing smaller, dry sticks over the top. Progressively build the fire bigger.

On rainy days it may be necessary to build a makeshift fire shelter from large leaves such as palm or fern fronds, dead branches, or by using the underside of a large log to protect your startup fire.

When gathering firewood, always search out standing dead wood since it sheds more water than dead wood lying on the ground. The middle portions of standing dead trees will be dry. You can also break apart fallen dead wood for the drier center portion.

In a worst-case scenario, you can also use various items from a first-aid kit to help start a fire. Some insect repellents, ointments, alcohol prep pads, hand sanitizers and other first aid items are highly flammable.